

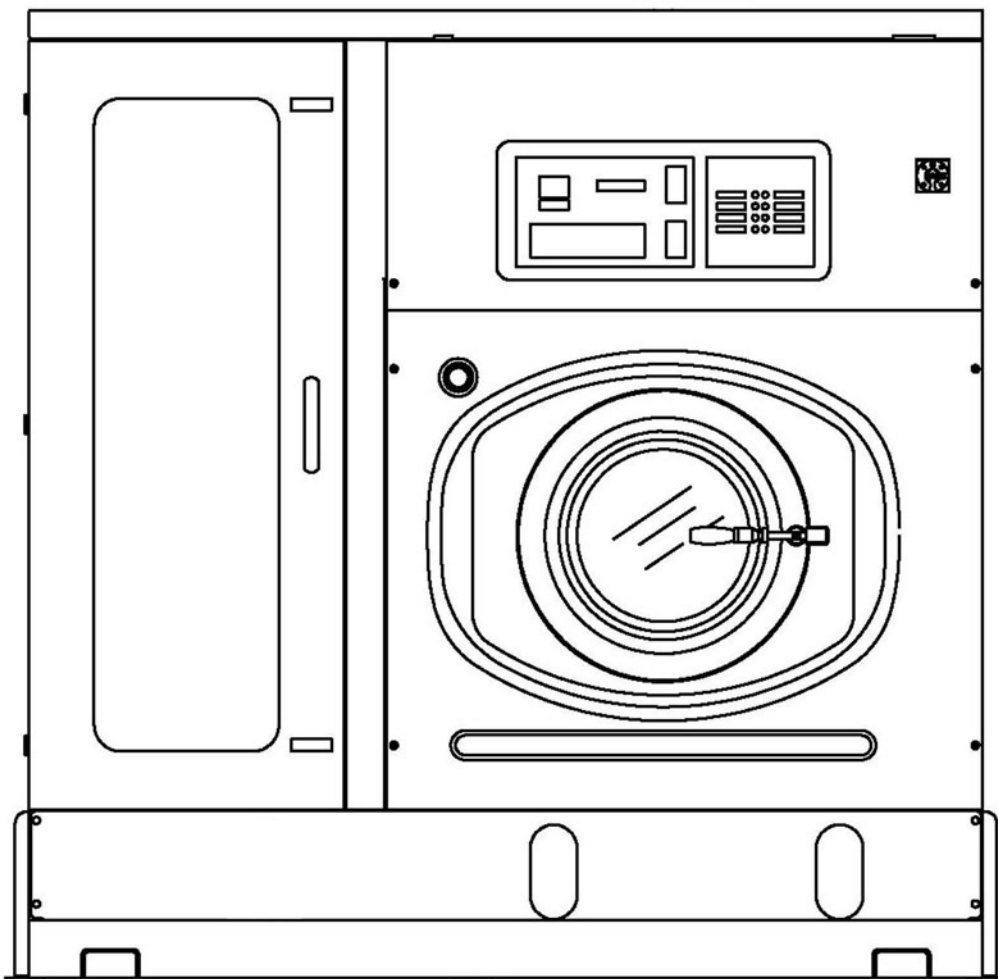

TECHNICAL INFORMATION



NOVA 40E



WORKING MACHINE WITH SOLVENT	HYDROCARBON	
MACHINE CAPACITY	18 Kg	40 Lbs

BASKET		
Diameter	900 mm	35.4 inches
Depth	535 mm	21 inches
Volume	340 Lt	12 cu.ft
Wash speed	20 ÷ 55 rpm	
Extract speed	300 ÷ 520 rpm	
Door opening	500 mm	20 inches

SOLVENT TANKS		
Useful volume tank 1	110 Lt	29 gal
Useful volume tank 2	110 Lt	29 gal
Useful volume tank 3	- Lt	- gal
FLOOR SAFETY TANK CAPACITY	360 Lt	95 gal

DECANTER FILTER		
Total volume	32 Lt	8.4 gal

ELECTRIC POWER	400V - 3~50Hz		220V - 3~60Hz	
Wash - Extract (With Inverter)	*1.7 Hp	*1.3 Kw	*1.7 Hp	*1.3 Kw
Solvent pump motor 1	1 Hp	0.75 Kw	1 Hp	0.75 Kw
Solvent pump motor 2	1 Hp	0.75 Kw	1 Hp	0.75 Kw
Fan motor	2 Hp	1.5 Kw	3 Hp	2.25 Kw
Refrigerator compressor	5 Hp	3.75 Kw	5 Hp	3.75 Kw
Nylon filter motor	0.75 Hp	0.55 Kw	0.75 Hp	0.55 Kw
Remote condenser	0.42 Hp	0.32 Kw	0.42 Hp	0.32 Kw
Air motor compressor (optional)	0.5 Hp	0.37 Kw	-	-

* POWER CHANGES ACCORDINGLY TO THE USE OF THE MACHINE

NOTE: Acoustic emission level of the machine is lower than 70 dB (A)

FILTRATION AVAILABLE IN THIS MODEL
ONE NYLON FILTER

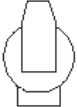
	Volume nylon filter housing	55 Lt	<i>14,5 gal</i>
	Nylon filter area	3,9 mt²	<i>42 ft²</i>
	Filter disks	26 nr	

ONE NYLON FILTER AND ONE LARGE CARTRIDGE - KR

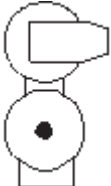
	Volume nylon filter housing	55 Lt	<i>14,5 gal</i>
	Nylon filter area	3,9 mt²	<i>42 ft²</i>
	Filter disks	26 nr	
	Vol. large cartridge housing KR	55 Lt	<i>14,5 gal</i>
	Area large cartridge KR	2,6x2=5,2 mt²	<i>28x2=56 ft²</i>
	Cartridges quantity KR	nr 2	



DIMENSIONS AND WEIGHTS

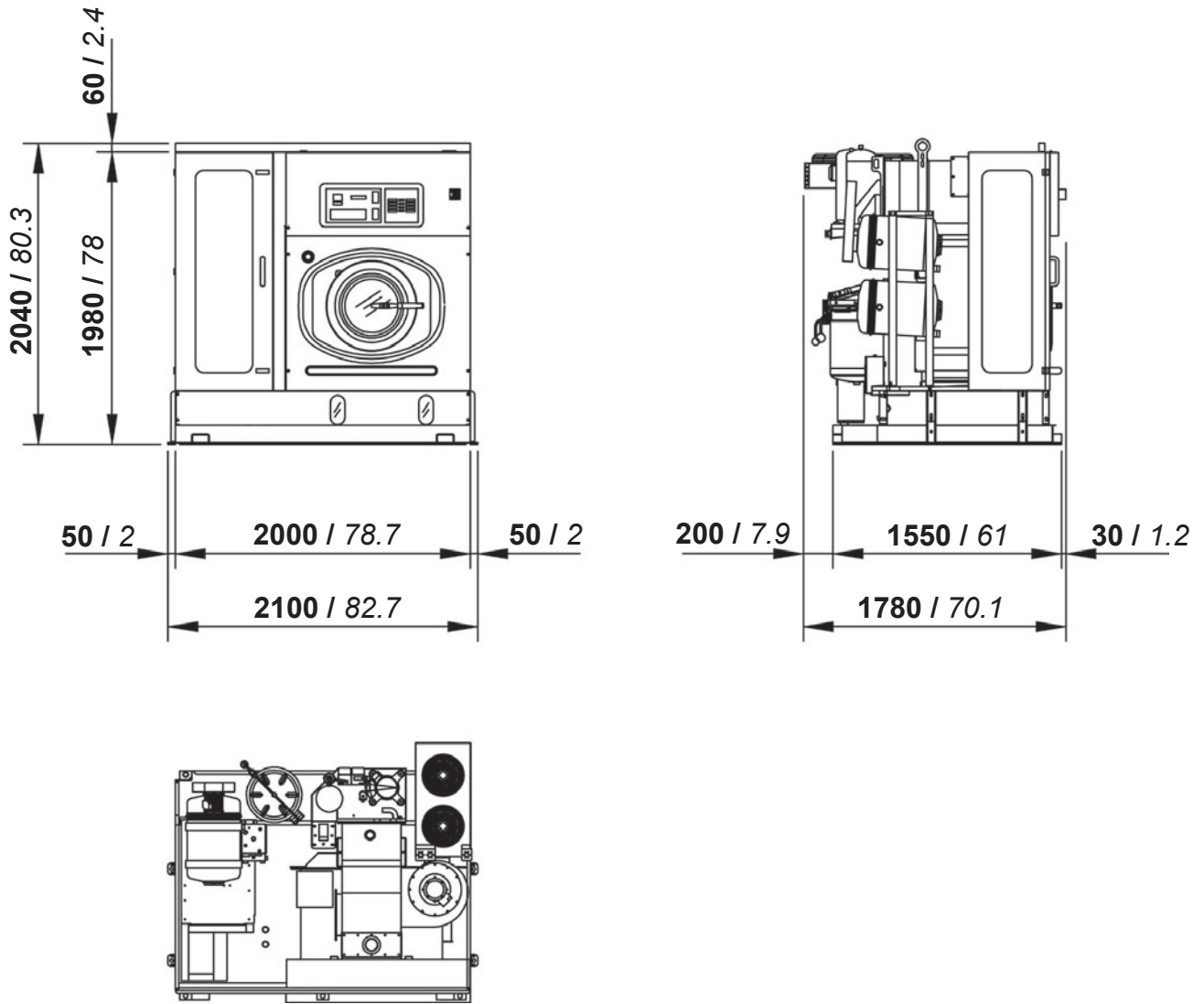

mm / inches

CHARGES - STANDARD VERSION		
Empty machine weight	1550 Kg	3417 Lbs
Machine weight with solvent	1804 Kg	3977 Lbs
Static charge on the floor with solvent	582 Kg/m²	119 Lbs/ft²
Dynamic charge on the floor (+10%)	906 Kg/m²	186 Lbs/ft²



PACKAGED MACHINE DIMENSIONS AND WEIGHTS

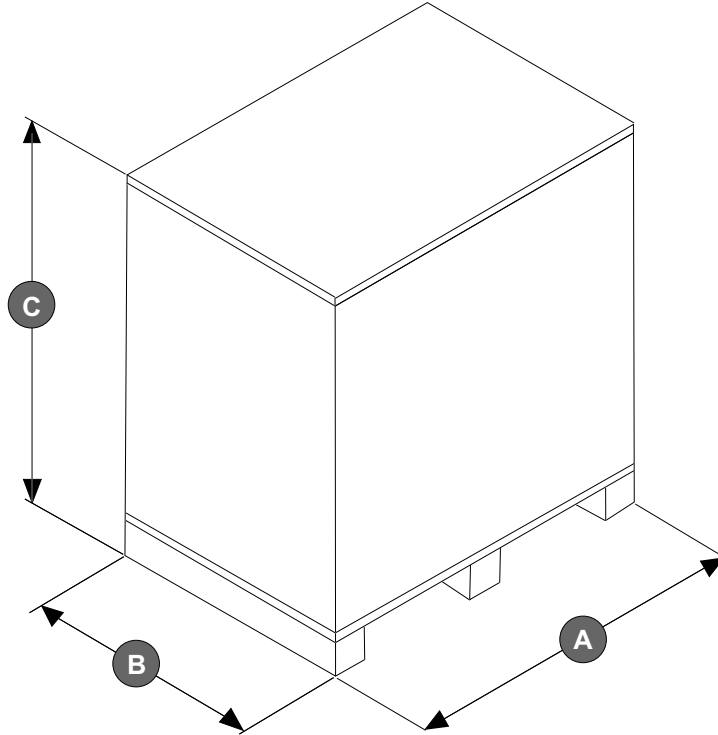

PACKAGED MACHINE DIMENSIONS							
Machine type		Carton		Wooden cage		Wooden case	
Standard	A	- mm	- inches	2280 mm	- inches	- mm	- inches
	B	- mm	- inches	1540 mm	- inches	- mm	- inches
	C	- mm	- inches	2425 mm	- inches	- mm	- inches

PACKAGED MACHINE WEIGHTS						
Machine type	Carton		Wooden cage		Wooden case	
Standard	1645 Kg	3626.6 Lbs	1675 Kg	3693 Lbs	- Kg	- Lbs



FIXING POINTS WITH FLOOR TANK

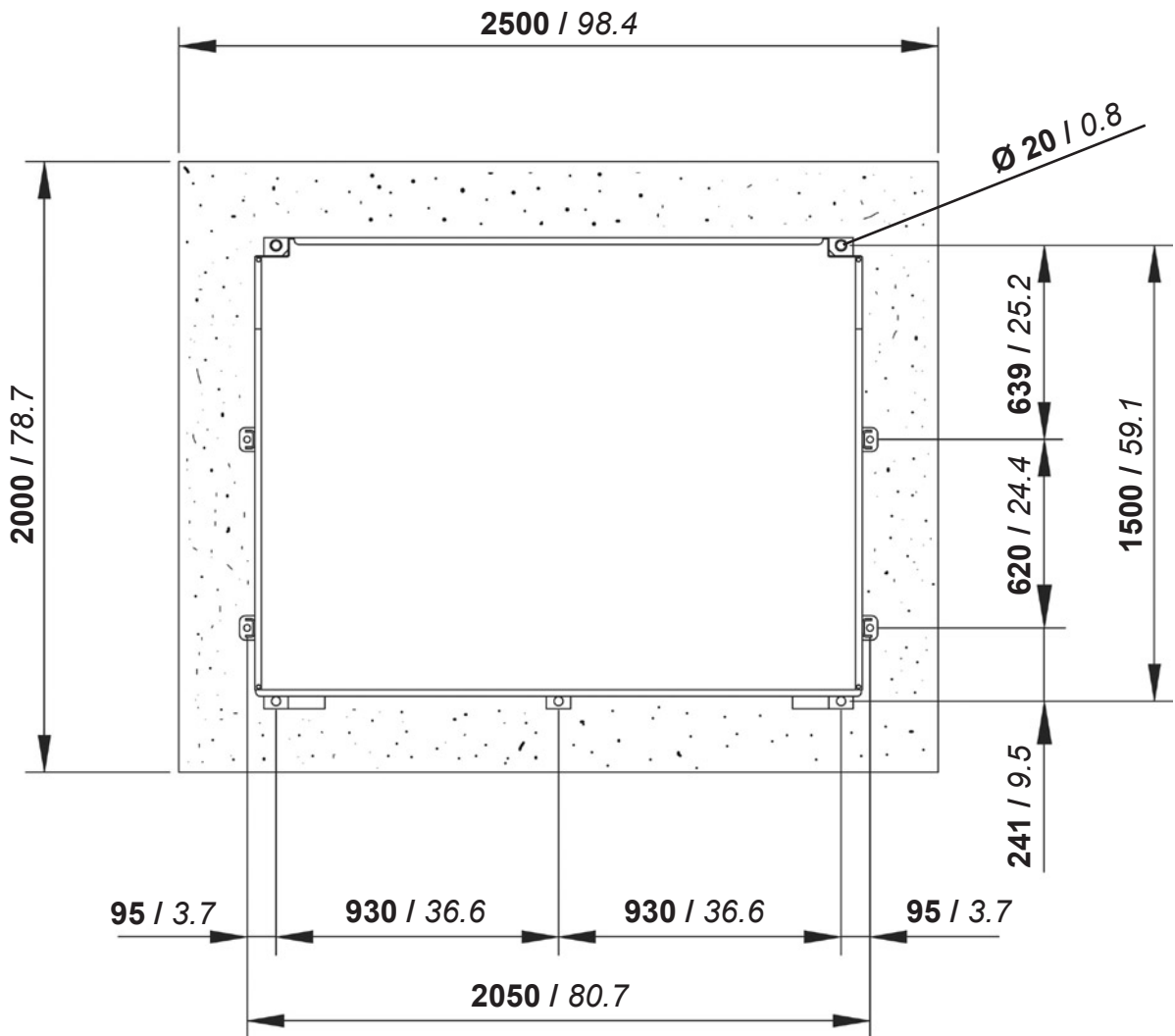
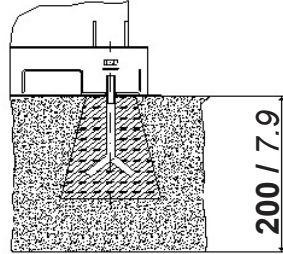

mm / inches



CONNECTIONS

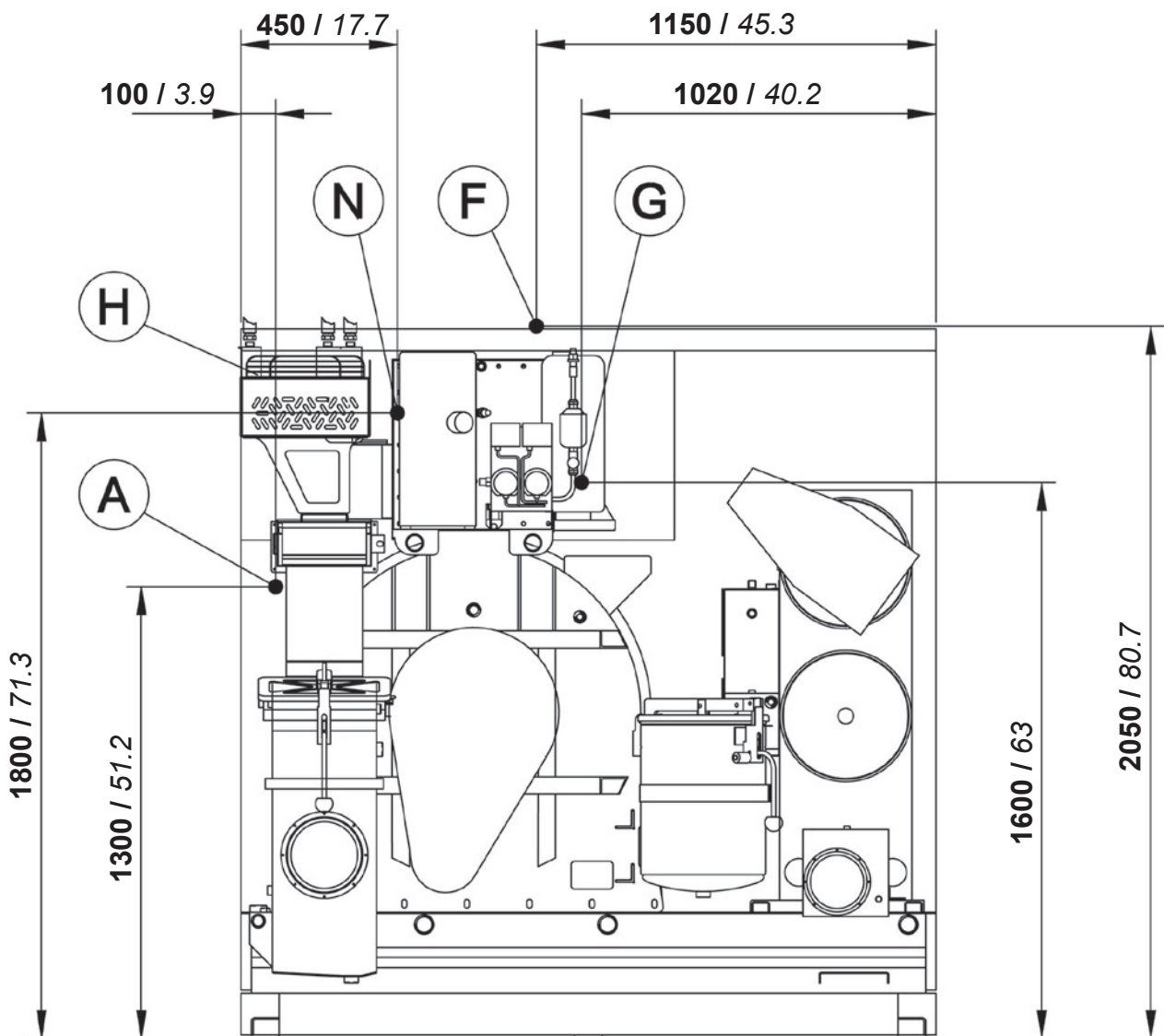

mm / inches

A	Compressed air inlet	mm 6	Ø 1/4"
B	-	-	-
C	-	-	-
D	-	-	-
E	-	-	-
F	Steam heater inlet (Opt.)	Ø 1/2"	
G	Condensate heater outlet (Opt.)	Ø 1/2"	
H	Electric connection		
N	Nitrogen feeding connection (N ₂)		



SOLVENT TYPE	HYDROCARBON			
NECESSARY QUANTITY OF SOLVENT TO FILL THE MACHINE				
Machine version - 1 Nylon Filter	275 Lt	212 Kg	72.5 gal	467 Lbs
Machine version - 1 Nylon Filter + 1 KR	330 Lt	254 Kg	87 gal	560 Lbs

INFORMATION FOR THE ELECTRICAL CONNECTIONS		(400V - 3~50Hz)	
Standard Version	8 Kw	20 Amp	
Dissipated heat	- Kcal		

INFORMATION FOR THE ELECTRICAL CONNECTIONS		(220V - 3~60Hz)	
Standard Version	9 Kw	30 Amp	
Dissipated heat	- Kcal		

GENERAL INFORMATION		
Required water capacity	-	-
Required water pressure	-	-
Required water temperature	-	-
Required air pressure	bar 7 ÷ 8	psi 100 ÷ 115
Required steam pressure (Steam Version)	bar 4 ÷ 5	psi 55 ÷ 70
Required steam availability (Steam Version)	Kg/h 15 ÷ 20	Lbs/h 33 ÷ 44

All technical data are subject to change without notice.